

The **Gutta Easy** is a highly efficient gutta percha back fill obturation device.

With its distinctive and inimitable features, the Gutta Easy makes thermo-plasticized root canal obturation much easier and faster than ever. The Gutta Easy's powerful and rapid heating control mechanism delivers reliable and optimum clinical results.

Easy Swivel

Power On/Off

Temperature Control
(160°C / 180°C / 200°C)

Temperature Display

Multy Tool



features

- Ergonomic and user -friendly operation
- Reduces hand and wrist fatigue and increases precision to hard-to-reach areas
- Effective heating control mechanism
- Adjustable 3 temperature settings (160°C / 180°C / 200°C)
- 2 available tip sizes (23G / 25G)
- Convenient and easy obturation with predictable results



advantages

> Speed

3 temperature settings (Low / Medium / High):
Low = 160°C / Medium = 180°C / High = 200°C



0°C - 220°C =
23 seconds

> Efficiency

'Easy Swivel (patent)' provides better access to hard-to-reach areas and increases precision of thermo-plasticized back fill obturation

Gutta Easy: Easy Swivel (Patent) >>

WIPO PATENT # : PCT / KR2009 / 003683

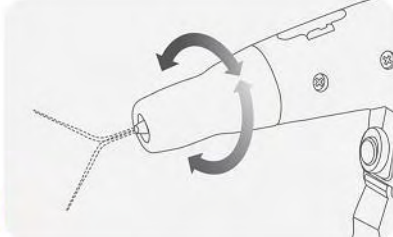

specifications

Operating Time	1 hour and 45 minutes	
Operating Temperature	160°C / 180°C / 200°C	
Charging Time	2 hours and 30 minutes	
Weight	Gutta Easy (Gun)	200g (7oz)
	Charging Station	280g (9.8oz)
	AC Adapter	200g (7oz)
Input Power	AC 100~250V, 50~60 Hz	
Output Power	6V DC, 2.5A	

components



Gutta Easy Gun (G-1001)



Charging Station (GE-1002)



Hand Piece Prop (GE-1003)



Plunger (GE-1008)



Gutta Easy Gun Tip: 23G/25G (GE-1004-23, 25)



Thermal Protector (GE-1005)



Teflone Cleaning Brush (GE-1006)

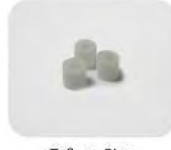

Teflone Ring (GE-1007)



Gutta Percha Pellet: Soft / Medium (GE-1009-S, M)



Multy Tool (GE-1010)



AC Adapter (AC-1002)



AC Power Cord (AC-1001)

clinical case study



1. Select and fit a master apical cone that is equivalent in size to the taper of the canal being obturated.



2. Adjust and mark the length with the silicone stopper after selecting a Friendo pen tip inserted shortly to 3~4mm than working length.



3. Dehydrate root canal with paper points. Apply sealer wax on the master cone to 2~4mm, and insert it to the root canal. Then cut the excess over the orifice by using the Friendo pen tip with gutta percha to 3~4mm short of the working length.



4. Harden the melted gutta percha with pre-selected plugger tip. Now apical area and accessory canal are thoroughly filled (1/3) and obturated.



5. Insert the Gutta Easy injection pipe into the root canal, then wait for 5 seconds in order to start softening process of obturated gutta percha inside the root canal.

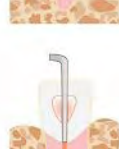

6. Pull the trigger slowly and fill the gutta percha up to the root canal. Injection pipe gets pushed away naturally from the area being treated by back-filling pressure.



7. Harden and compact the heated gutta percha with bigger plugger.